



## 6PLAYER™, MULTI-PLAYER ADAPTOR

Thank you for your purchase of the 6Player. Please read the following instructions carefully before use.

### MAINTAINING YOUR 6PLAYER

#### LOCATION

Avoid the following conditions during use or storage:

- high temperatures, such as in direct sunlight or near a heater;
- extreme cold;
- steam vapor, such as near a kitchen stove;
- dust;
- areas where the unit may be splashed with water;
- humidity;
- slanted, unstable or vibrating surfaces.

**Note:** Condensation may accumulate on the surface of the unit if it is subjected to sudden changes in temperature. In this case, allow the unit to rest for about an hour before use.

#### CONSOLE

- Never disassemble or alter the console or any other components.
- Avoid shocks, such as impact from dropping the unit on the floor.
- Use water or diluted neutral detergent to clean the product. Do not use benzene or thinner.

#### CABLE

- Do not forcibly bend or pull the cable.
- Do not place heavy objects on the cable.
- Hold the plug in your hand while removing the cable.

**Caution:** If the cable becomes damaged, and the core wires become exposed, stop using the 6Player immediately and contact our customer service department or your Sega dealer. Continued use constitutes a risk of electric shock or fire.

#### USAGE ENVIRONMENT

Use this product under the following conditions:

- Temperature—41°F to 95°F (5°C to 35°C)
- Humidity—20% to 80% RH

---

IF YOU WOULD LIKE TECHNICAL ASSISTANCE WITH ANY SEGA PRODUCT,  
PLEASE CALL OUR CUSTOMER SERVICE DEPARTMENT AT 1-800-USA-SEGA.

## CONNECTING THE 6PLAYER

### Caution

- Make sure the Sega Saturn power is off before connecting or disconnecting all components, including the 6Player.
- If you disconnect the 6Player from the Sega Saturn midgame, wait 10 seconds and then reconnect. You can continue your game from where you left off.
- Do not connect a 6Player to another 6Player.
- Only for use with software which is compatible with the 6Player.

### FOR THREE- TO SEVEN-PLAYER GAMES

1. Connect the 6Player to Control Port 2 of the Sega Saturn.
2. Connect the Sega Saturn Control Pads or other Sega Saturn peripherals to the 6Player.

### FOR EIGHT- TO TWELVE-PLAYER GAMES

1. Connect the first 6Player to Control Port 1 of the Sega Saturn.
2. Connect the second 6Player to Control Port 2 of the Sega Saturn.
3. Connect the Sega Saturn Control Pads or other Sega Saturn peripherals to the 6Players.

Three- to Seven-Player Games

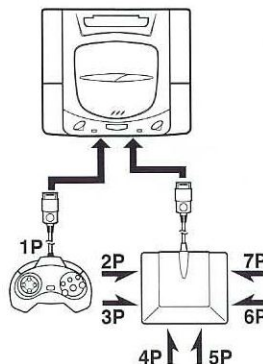

Eight- to Twelve-Player Games

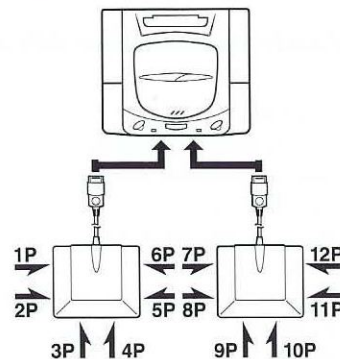

**Note:** The 6Player is provided with coded seals to help you in making the proper connections. Be sure to match the seals on the cables with those on the 6Player console.